

Lighting & Atmosphere  
9/10

Composition  
10/10

Materials & Scene Setup  
9/10



*A highly graded composition for multiple reasons, including the strong use of the rule of thirds. The camera positioning places the architectural elements close to the intersection points, creating a balanced and visually engaging frame.*

*The red lines highlight the perspective of the pool leading toward the entrance of the house, while the pink line emphasizes how clearly the sloped context is represented within the render. The green indicates the background trees, and the blue represents the negative space of the sky, all contributing to a well-balanced composition.*

*Fun fact — even the placement of the dog near the entrance and the goat within the farm area feels logical and intentionally positioned, adding life to the scene.*



Eastern  
Mediterranean  
University



 D5 RENDER

Lighting &  
Atmosphere  
9/10

Composition  
9/10

Materials &  
Scene Setup  
9/10



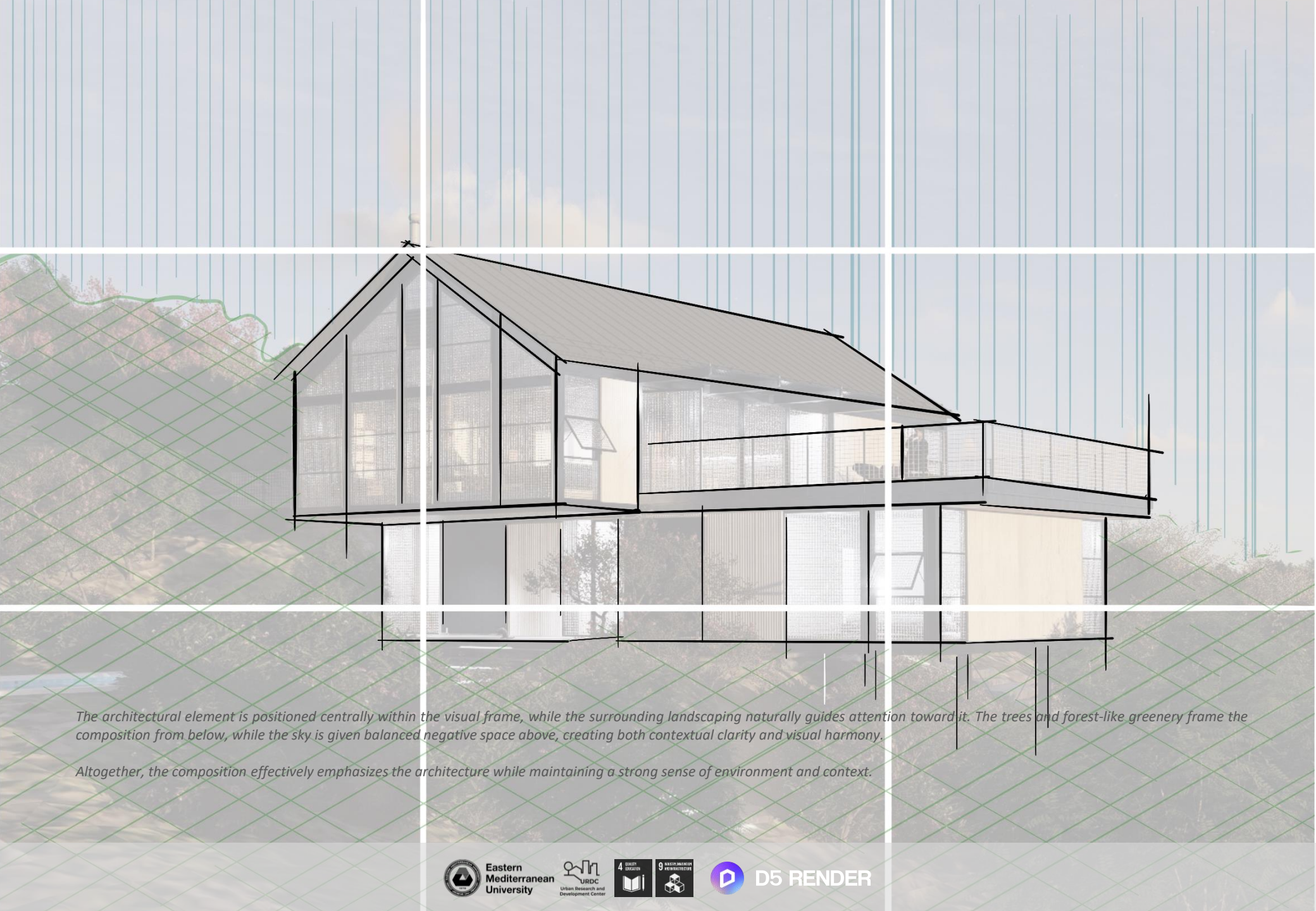

*The architectural element is positioned centrally within the visual frame, while the surrounding landscaping naturally guides attention toward it. The trees and forest-like greenery frame the composition from below, while the sky is given balanced negative space above, creating both contextual clarity and visual harmony.*

*Altogether, the composition effectively emphasizes the architecture while maintaining a strong sense of environment and context.*



Lighting &  
Atmosphere  
9/10

Composition  
10/10

Materials &  
Scene Setup  
7.5/10

*One of the strongest aspects of this shot is the sense of surprise and curiosity it creates, as the entire architecture is not immediately exposed within the frame. The stairs naturally guide the viewer toward the entrance, while the camera positioning enhances the overall journey through the scene.*

*The dense, forest-like greenery on both sides frames the house effectively and directs attention toward the key architectural elements of the render. Overall, the image successfully communicates the feeling of a secluded forest retreat immersed within nature.*

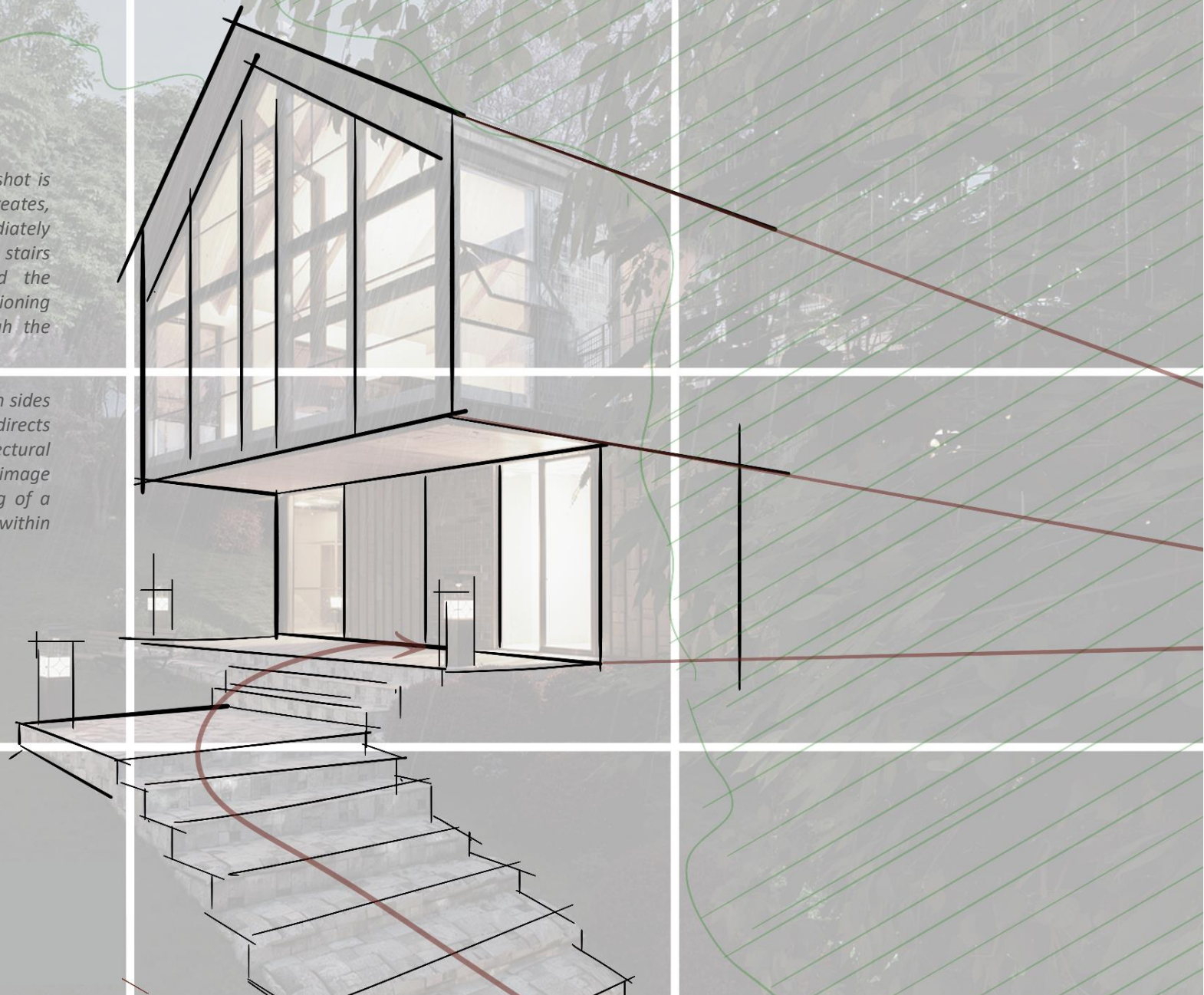

Eastern  
Mediterranean  
University



D5 RENDER